

PARTS CATALOGUE

Cal. 6M23A

[SPECIFICATIONS]

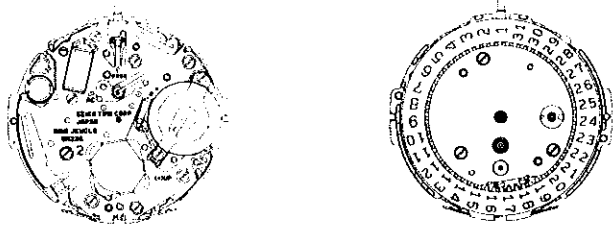

| | | Cal. No. | 6M23A |
|---------------------------------|------------------|--|-------|
| Item | | | |
| Movement | |  <p>(x 1.0)</p> | |
| Movement size | Outside diameter | 28.5 mm between 6 o'clock and 12 o'clock sides ø27.0 mm between 3 o'clock and 9 o'clock sides | |
| | Casing diameter | ø26.4 mm | |
| | Height | 3.7 mm (3.9 mm including the battery portion) | |
| Time indication | | 3 hands, 24-hour hand and mode indicator | |
| Driving system | | Step motor (4 pcs.) | |
| Additional mechanism | | <ul style="list-style-type: none"> • Alarm function (24-hour indication system) • Stopwatch function (Up to 32 days) <ul style="list-style-type: none"> • It measures in 1/10 second increments for the first 60 minutes. • Automatic calendar (Year, month and date up to the year 2099) • Dual time function • Hands 0-reset adjustment function (including the date position adjustment) • Alarm test system • Confirmation sound for watch operation • Electronic circuit reset switch • Battery life indicator | |
| Loss/gain | | Monthly rate at normal temperature range: less than 15 seconds | |
| Regulation system | | Nil | |
| Measuring gate by quartz tester | | Use 10-second gate (in "CHRONO Ø MATCH" mode). | |
| Battery | | SEIKO SR927W, Maxell SR927W, SONY SR927W, EVEREADY 399 Battery life is approximately 2 years. Voltage: 1.55V | |
| Jewels | | 9 jewels | |

SEIKO CORPORATION

PARTS CATALOGUE

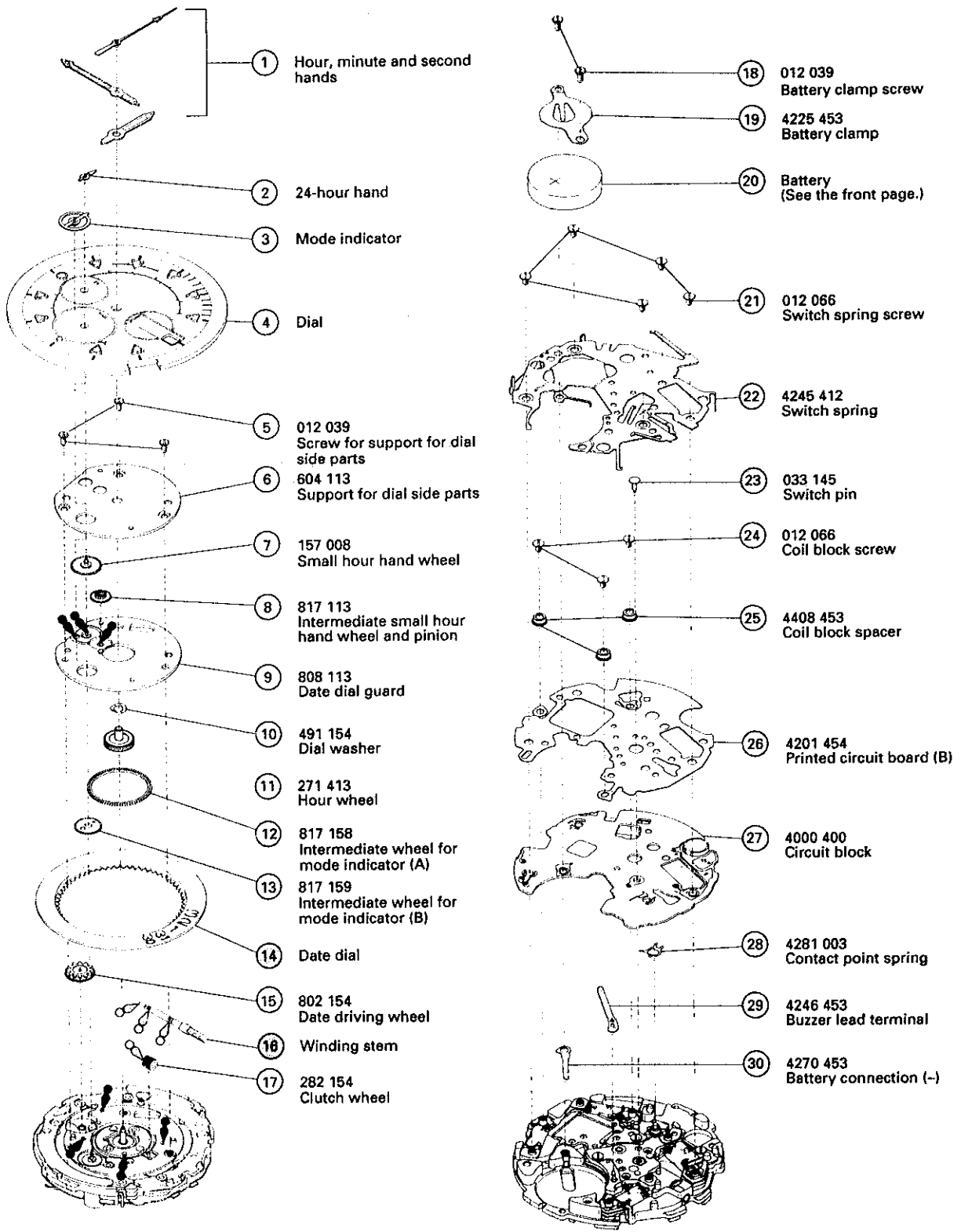
Cal. 6M23A



  Please see the remarks on the next page.

PARTS CATALOGUE

Cal. 6M23A

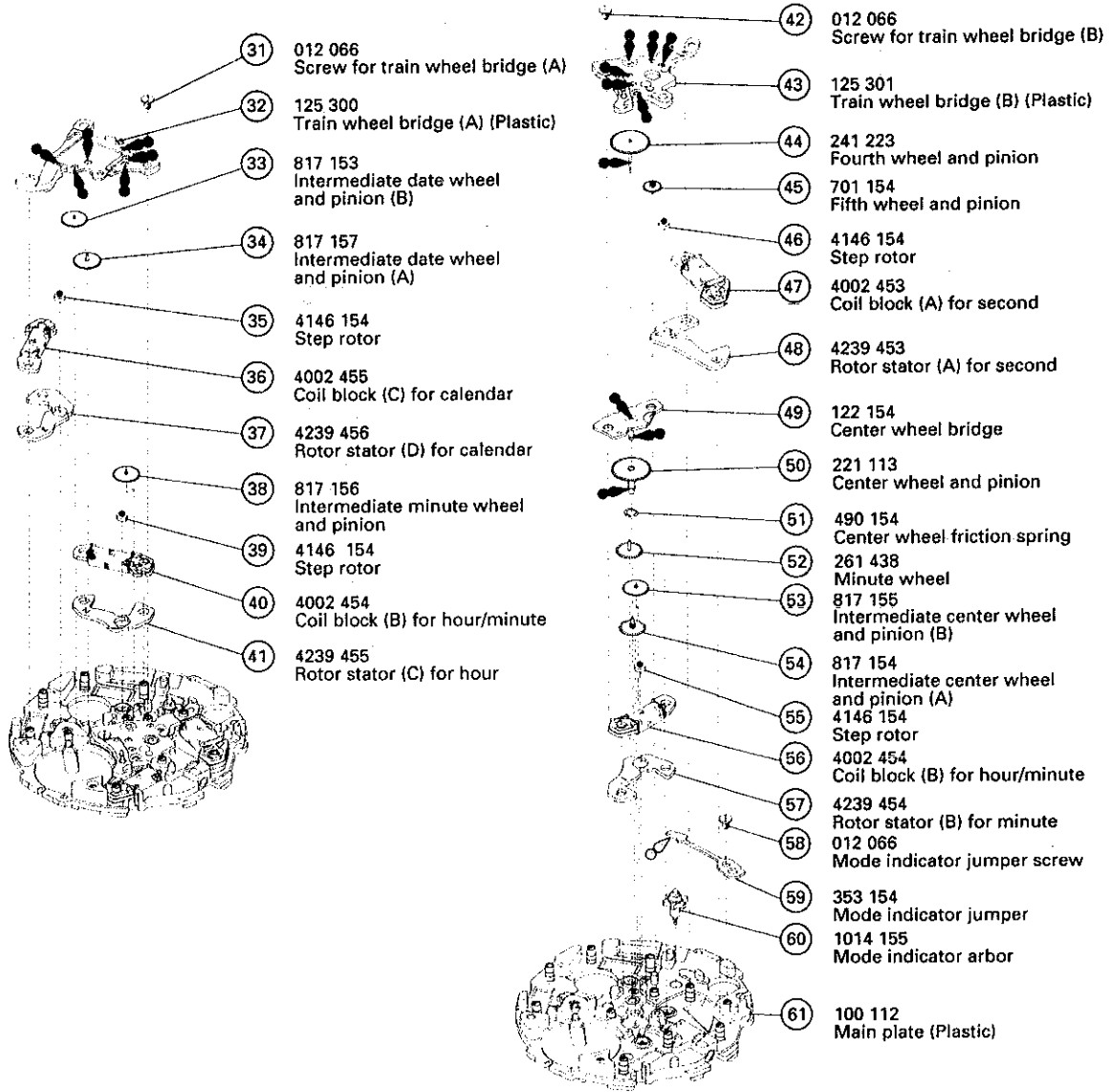

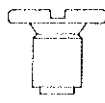
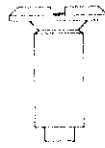
| | |
|---|---|
|  | <p>012 066</p> <ul style="list-style-type: none"> • Switch spring screw (5 pcs.) • Coil block screw (3 pcs.) • Screw for train wheel bridge (A) (1 pc.) • Screw for train wheel bridge (B) (1 pc.) • Mode indicator jumper screw (1 pc.) |
|  | <p>012 039</p> <ul style="list-style-type: none"> • Screw for support for dial side parts (3 pcs.) • Battery clamp screw (2 pcs.) |

Remarks:

- ⑭ Date dial
- ⑯ Winding stem

The type of date dial and winding stem are determined based on the design of cases. Check the case number and refer to "SEIKO Casing Parts Catalogue" to choose their corresponding types.

• For the remarks on assembling, disassembling and value checking of Cal. 6M23A, refer to "TECHNICAL GUIDE" section of "PARTS CATALOGUE/TECHNICAL GUIDE Cal. 6M13A".